



STEP TWO INSTALL COMBIPHOS

Your Combimate can be used to offer two different levels of protection, complete system protection or single appliance protection. Inside the dome is a removable Divider Tray which allows you to select the quantity of Combiphos that the Combimate can hold.

Single appliance protection
Divider Tray to remain in place (place 400g of Combiphos on to tray)

Complete system protection

Divider Tray must be removed (fill dome with 800g of Combiphos)

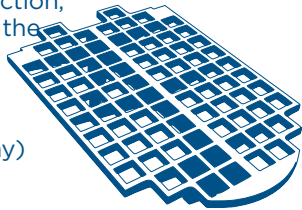

WARNING: Soldering flux will damage plastic. Ensure no flux comes into contact with the Combimate.

Contact with soldering flux will cause eventual deterioration of the material and lead to leaks.

1. Offer the Combimate to pipework and connect. When tightening the compression fittings it is essential to **HOLD THE INNER NUT WITH A SECOND SPANNER**: this should prevent damage to the Combimate by over-tightening the compression fitting thread which enters the plastic body.
2. Depress the two red buttons located at either side of the cover and pull the cover away from the unit.
(With the cover removed, water flow through the unit is shut off). (Fig 1).
3. Place a bowl under unit to catch any residue. Unscrew the red filler plug from the top of the dome using the spanner provided. (Fig 2).
4. Unscrew and remove the aluminium ring. Ease the translucent dome away from the base section noting the location of the large 'O' ring seal on the inside ledge of the base. Remove the Divider Tray if required.
5. Ensure the ledge for the 'O' ring is clean and fit 'O' ring seal in place. (Ensure the 'O' ring sits on ledge inside the white base; it does not fit over the dome).
6. Replace the dome, ensuring the locating lugs line up and the dome is fully pressed home.
7. Using hand pressure only, secure and tighten the aluminium ring in a clockwise direction. (Should a leak occur, check for damage or small particles lodged behind the 'O' ring). (Fig 3).
8. If the premises are or will be occupied, fill the dome with the required amount of Combiphos by pouring it through the hole in the top of the dome.
9. Before refitting the red filler plug, ensure all air is bled from the Combimate. Open an outlet downstream of the Combimate and turn on the water supply; a low flow is adequate. Gently press back (towards wall) the black isolation levers located either side of the dome; this will allow water to enter the Combimate and expel any trapped air. Release the levers before water spills out of the filler hole and refit and tighten the filler plug using the spanner provided.
10. Turn on the water supply. Slide retaining hook on to outer cover as shown and refit the retaining cover on to the base, ensuring it clicks into place; this will engage the water supply. (Fig 4).
11. Check for leaks, attach Reminder Tag to pipework and hang spanner on to retaining hook.
12. Register your Combimate and activate your guarantee.

WARNING:
It is important that no soldering flux comes into contact with the plastic body of the Combimate.

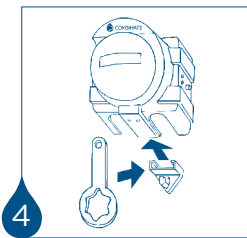
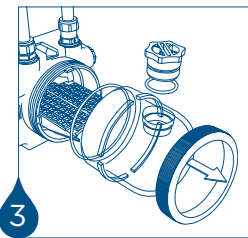
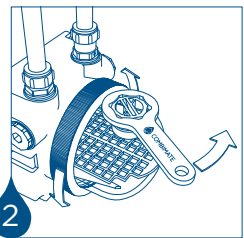
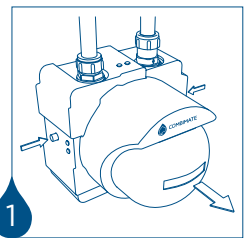

Specification

Max Pressure: 6.5 bar static (100psi) Fittings: compression (15mm or 22mm pipe)

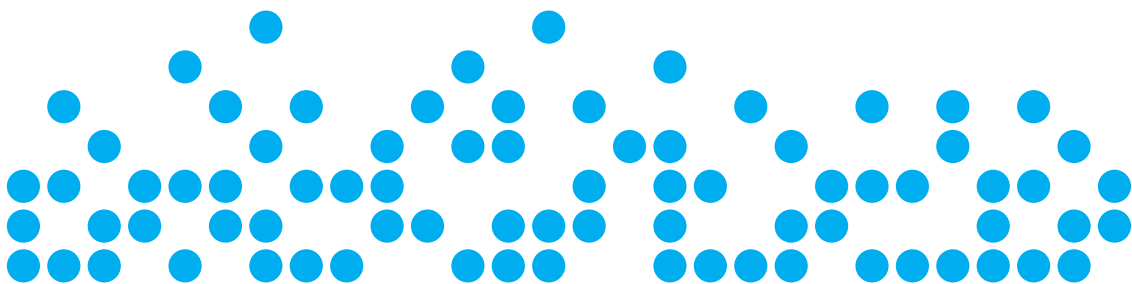

STEP THREE ACTIVATE LIFETIME GUARANTEE

Your Combimate has been manufactured under the ISO9001:2015 quality assurance scheme and is a WRAS approved product that's covered by a 3-year manufacturer's warranty** against defective materials and workmanship. This excludes soldering flux damage or over-tightening of fittings.

Lifetime Scale Prevention Guarantee

Cistermiser Ltd. guarantees that Combimate will prevent the build-up of limescale deposits within the hot water system when fitted to a new heat exchanger, combination boiler or thermal store.

We shall contribute up to £500* towards the repair, descale or replacement of any hot water heat exchanger within a combination boiler or thermal store that is protected by a Combimate[†].

PLEASE VISIT OUR WEBSITE FOR FULL TERMS AND CONDITIONS www.combimate.co.uk

*including VAT

**when installed and maintained with manufacturer's instructions

Product must be registered to extend warranty to three years.

Our commitment:

[†]We shall contribute up to £500* towards the cost of the de-scaling, repair or replacement of your heat exchanger, combination boiler or thermal store if:

- Scale contamination becomes evident within 12 months of the last Combiphos top-up.
- The volume of Combiphos has been maintained and replaced in accordance with the recommendations.
- The lower portion of this card is completed and returned at the time of installation and a copy of the receipt is included for the installation of the new heat exchanger, combination boiler or heat store.
- Installation of the Combimate has been carried out in accordance with the manufacturer's instructions.
- The boiler, heat exchanger or heat store was new at the time of the installation of the Combimate.

Detach, moisten, fold and seal along the edges

Once your Combimate is installed please complete and return the card below or register online at www.combimate.co.uk

PLEASE USE BLOCK CAPITALS

Serial No. Date Installed
(on the side of the base, once the cover is removed)
Protection selected (tick one): ☐ Complete supply or ☐ Single appliance

Make and model of boiler..... Approx. age

Yes, I wish to receive an annual Combiphos reminder, to be sent by:

- ☐ **Post** (tick one)
☐ **Email** (tick one)

OPTIONAL - TO APPLY FOR THE LIFETIME SCALE PREVENTION GUARANTEE, PLEASE INCLUDE:

- ☐ New boiler installation receipt (tick one)
☐ New heat exchanger installation receipt (tick one)

Name and address of Homeowner:

.....

.....

.....

Post Code Email

Signed

OPTIONAL - TO BE COMPLETED BY THE INSTALLER:

Yes, I wish to receive trade news updates about Combimate and Cistermiser's associated water-saving products to be sent by:

- ☐ **Post** (tick one)
☐ **Email** (tick one)

Name and address of installer:

.....

.....

Post Code Email

Detach, moisten, fold and seal along the edges



STEP FOUR REFILL

REMINDER TAG

1. Complete details & detach tag
2. Attach on to pipework



Combimate
GUARANTEED LIMESCALE PREVENTION

This is a limescale prevention device.

To ensure your home remains protected we recommend the Combiphos spheres are replaced annually.

Date of installation

Date of next refill

.....

.....

.....

.....

.....

.....

.....

.....

.....

.....

.....

.....

.....

.....

.....



Scan to
order online

From **Cistermiser**
OUR WORLD IS WATER

Detach, moisten, fold and seal along the edges